

# Test Specimens

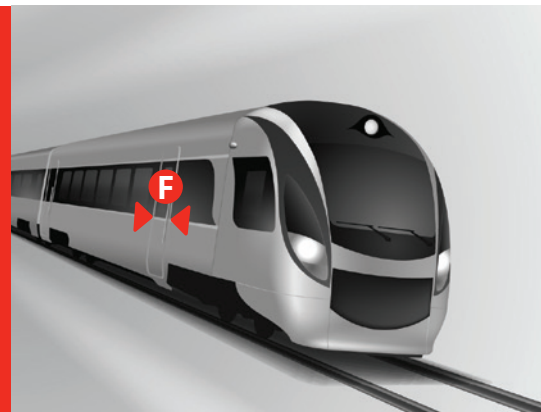

## Safety ensured by Pinch Force Measurement

**DriveTest GmbH** develops and produces test systems for the world-wide use in the automotive and railway industry. As one of the pioneering companies in the field of pinch force measurement **DriveTest** offers a broad range of different devices for a variety of applications. Every device supports the testing of pinch forces according to an applicable standard. Our customer service comprises the consultation, maintenance and calibration of the measuring devices. Major customers include the Deutsche Bahn and many municipal transportation departments.

"Schrift VDV 111" of "Verband Deutscher Verkehrsunternehmen (VDV)" describes the anti pinch requirements for powered train doors and door steps. With the examination of the vehicle doors accidents should be avoided, in particular accidents caused by the pinching of clothes or belts. The test specimen from DriveTest enable to test the protection devices according to the recommended test procedure of "Schrift VDV 111".

Test specimens 1, 2 and 3 serve to verify that trapped objects between the vehicle doors are recognized and to test if anti pinch actions are effective. The maximum extraction force needed for clamped test specimen can be measured with the help of the spring scale. For this the rotatable and swivelling hook of the spring scale is inserted into the aperture of the test device. When closing the doors, the test specimen is clamped. By pulling the handle of the spring scale, the maximum extraction force can be determined.

Test specimen 4 tests the safety of stepping on powered door steps.

Due to practical robustness, the test specimens deliver exact measurements, even after years of service in an industrial environment. The handling is easy and does not require any additional accessories.

The detailed test procedure is described in the DIN EN 14752 and "Schrift VDV 111".

- **Applicable standards** – DIN EN 14752, VDV 111 / VDV157
- **Function** – Anti pinch test for vehicle doors
- **Applicable for** – all kinds of rail cars
- **Robust construction** – manufactured from durable aluminum or stainless steel for long service life in industrial environments
- **Easy to use** – no accessories required
- **Delivery** – each test specimen separately or in a set (test specimens 1, 2 and 3) with precision spring scale and transportation case

# Test Specimens

Test specimens according to EN 14752 / VDV 111 / VDV 157

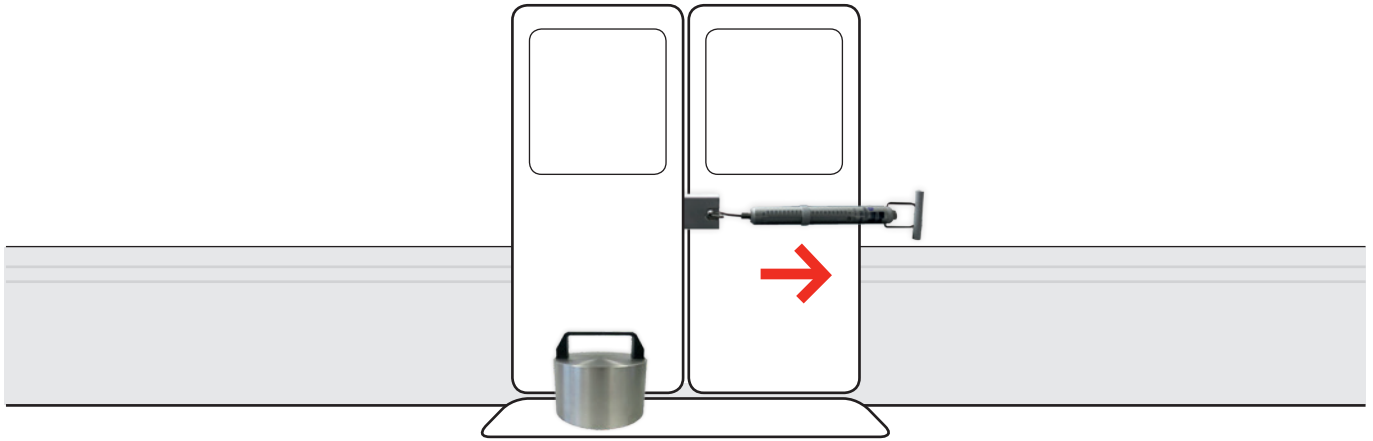

## Test specimen 1:

Anti pinch test for vehicle doors

Measures: 10 x 50 x 300 mm  
Material: Aluminium  
Weight: 0.4 kg



## Test specimen 2:

Anti pinch test for vehicle doors

Measures: 30 x 60 x 300 mm  
Material: Aluminium  
Weight: 1.4 kg



## Test specimen 3:

Anti pinch test for vehicle doors

Measures: 5 x 30 x 300 mm  
Material: Rubber band/stainless steel  
Weight: 0.1 kg



## Set of test specimens 1-3:

- Test specimens 1, 2 and 3
- Precision spring scale (Range: 200 N ± 1 % of measured value)
- Transportation case with foam inserts for complete delivery
- Calibration certificate of spring scale



## Test specimen 4:

Testing powered door steps

Measures: Ø 160 mm  
Foot: Ø 40 mm  
Material: stainless steel  
Weight: 15.3 kg

